

## NBB75FI

Isolated BNC bulkhead for panel mount,  
feedthrough

Neutrik's BNC bulkhead for panel mount offer a true 75  $\Omega$  design for serial and digital (HD & UHD) signals. The machined brass connector body provides an extremely rugged and non-abrasive connection over long term use.

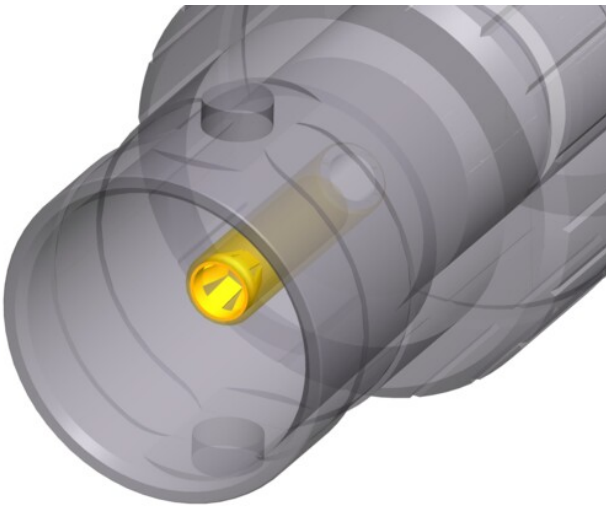

### Features & Benefits

- Gold plated cage type center contact
- True 75  $\Omega$  design meets the stringent HD & UHD requirements
- Isolated panel mount (solves potential grounding problems and prevents common-mode influence with other connections conducted over the same panel ground potential)
- Extra wide fastening nut avoids damaging the plastic thread

## New cage type contact

- Closed contact design - extremely robust
- Gold plated cage type clip - best possible shielding and lowest contact resistance

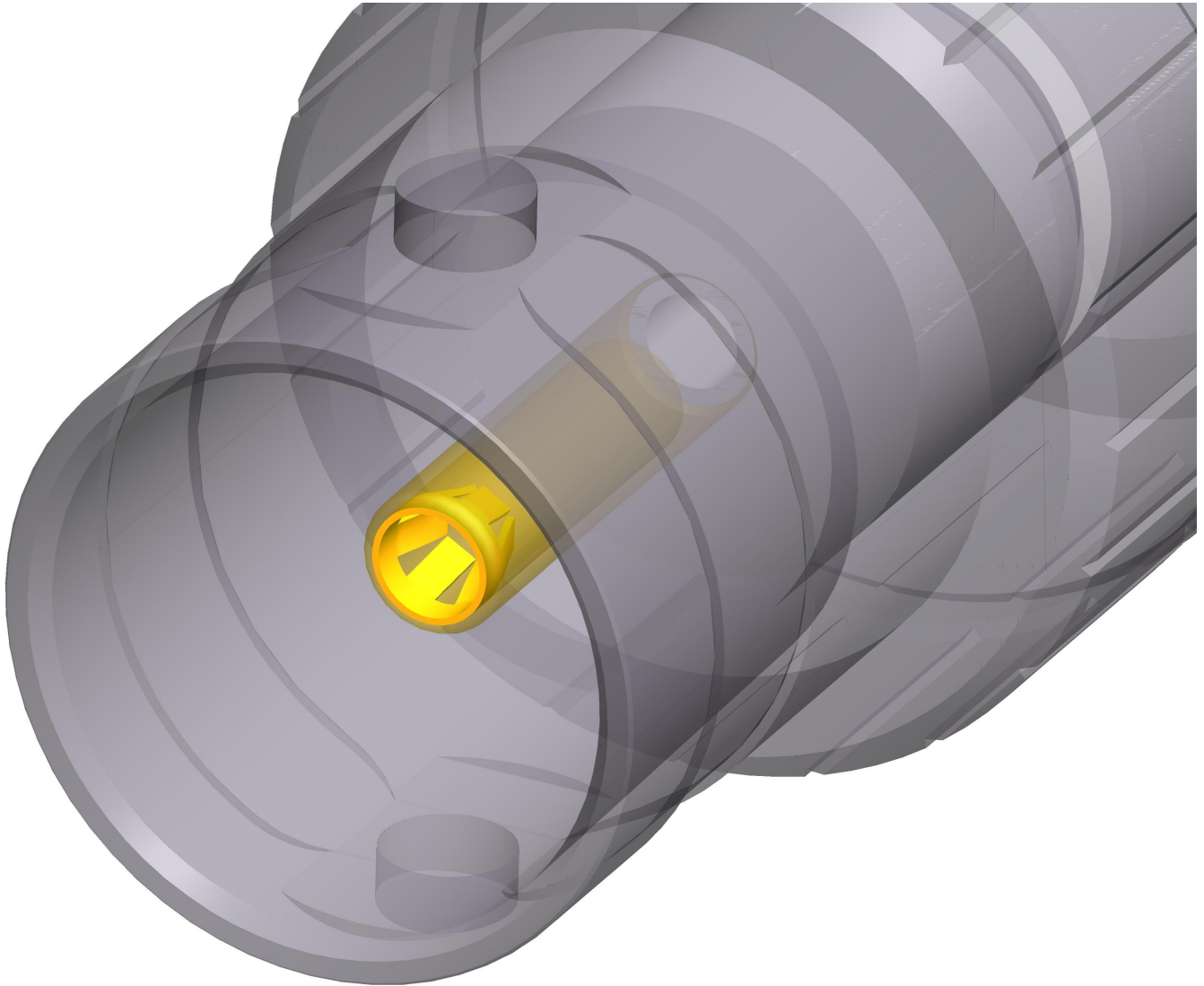

## Technical Information

| Product         |                 |
|-----------------|-----------------|
| Title           | NBB75FI         |
| Connection Type | BNC 75 $\Omega$ |
| Gender          | female          |

| Electrical            |                                                                                                                                        |
|-----------------------|----------------------------------------------------------------------------------------------------------------------------------------|
| Signal Type           | HD, SDI, Video, AES/EBU, Composit, YUV, RGB, RGBH, RGBHV UHD                                                                           |
| Contact resistance    | $\leq 3 \text{ m}\Omega$ (inner)                                                                                                       |
| Contact resistance    | $\leq 2 \text{ m}\Omega$ (outer)                                                                                                       |
| Dielectric strength   | 1,5 kVdc                                                                                                                               |
| Impedance             | 75 $\Omega$                                                                                                                            |
| Insulation resistance | $> 5 \text{ G}\Omega$                                                                                                                  |
| Rated voltage         | $< 50 \text{ V}$                                                                                                                       |
| VSWR                  | $\leq 1.050 / > 32 \text{ dB}$ up to 1 GHz<br>$\leq 1.065 / > 30 \text{ dB}$ up to 2 GHz<br>$\leq 1.100 / > 26 \text{ dB}$ up to 3 GHz |

| Mechanical         |                        |
|--------------------|------------------------|
| Insertion force    | $< 25 \text{ N}$       |
| Lifetime           | $> 1000$ mating cycles |
| Wiresize           |                        |
| Locking device     | Bayonett               |
| Mounting direction | Front mounting         |
| Chassis shape      | 12.7 mm                |

| Material      |                                                 |
|---------------|-------------------------------------------------|
| Contacts      | Brass (CuZn39Pb3), 0.2 µm AuCo (Center contact) |
| Insert        | PTFE                                            |
| Shell         | Brass (CuZn39Pb3)                               |
| Shell plating | Optalloy®                                       |

| Environmental     |                  |
|-------------------|------------------|
| Temperature range | -30 °C to +85 °C |